

REV.	SPECIFICATION	ECN NO.	APPD.

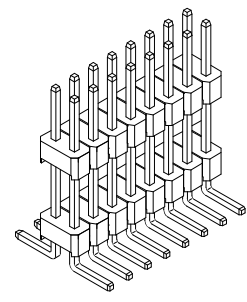
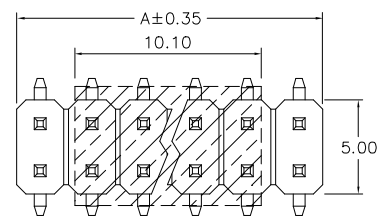

**Material:**  
Housing: PA6T,UL94V-0, Black.  
Contacts: Brass, Gold Plated or Matte Tin Plated over Nickel 50u".

**Electrical Characteristics:**  
Current Rating: 3 AMP.  
Dielectric Withstanding Voltage: AC 500V.  
Insulator Resistance: 1000MΩ min.  
Contact Resistance: 20mΩ max.  
Operating Temperature: -40°C~+105°C.

**\*RoHS Compliant**

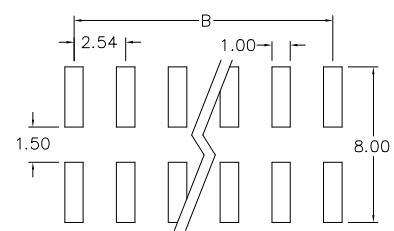
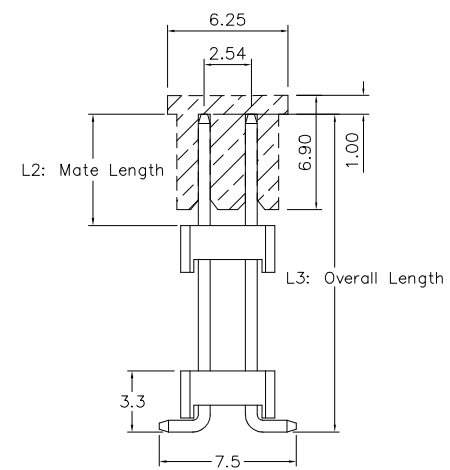
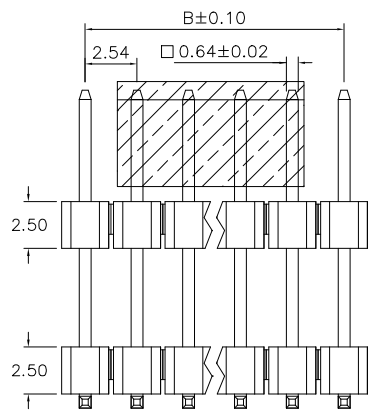

P.C. Board Layout

Series: 2012-  
Double Row: 2  
No. of Pin Per Row: xx  
G: Gold Plated  
MT: Matte Tin Plated  
00: Gold Flash  
10: 10u"  
15: 15u"  
30: 30u"  
Blank: For Matte Tin Plated

D: SMD Type  
-L2: Mate Length  
-L3: Overall Length  
T: Tape & Reel Package  
B: Bulk Package  
U: Tube Package  
P: Plastic Pad  
Blank: W/O Plastic Pad

Dimension					
Positions	A	B	Positions	A	B
2X02	4.83	2.54	2X22	55.63	53.34
2X03	7.37	5.08	2X23	58.17	55.88
2X04	9.91	7.62	2X24	60.71	58.42
2X05	12.45	10.16	2X25	63.25	60.96
2X06	14.99	12.70	2X26	65.79	63.50
2X07	17.53	15.24	2X27	68.33	66.04
2X08	20.07	17.78	2X28	70.87	68.58
2X09	22.61	20.32	2X29	73.41	71.12
2X10	25.15	22.86	2X30	75.95	73.66
2X11	27.69	25.40	2X31	78.49	76.20
2X12	30.23	27.94	2X32	81.03	78.74
2X13	32.77	30.48	2X33	83.57	81.28
2X14	35.31	33.02	2X34	86.11	83.82
2X15	37.85	35.56	2X35	88.65	86.36
2X16	40.39	38.10	2X36	91.19	88.90
2X17	42.93	40.64	2X37	93.73	91.44
2X18	45.47	43.18	2X38	96.27	93.98
2X19	48.01	45.72	2X39	98.81	96.52
2X20	50.55	48.26	2X40	101.60	99.06
2X21	53.09	50.80			

ie: 2012-2XxxG00D-6-17.2U  
6.0mm Mate Length(increment of 0.1mm)  
17.2mm Overall Length(increment of 0.1mm)

Tolerances	Dwg. No.	2012D01033		Title:	2012 Series			
.x = ±0.30	Projection	⊕ ⊖			Pin Header 2.54mmX2.54mm			
.xx = ±0.20	Unit	mm	Scale	1:1	Double Row Double Insulator			
	Drawn By	Martin 01/23'25		⌀535	S.M.D Type			

**OUPIN**  
**OUPIN ELECTRONIC(KUNSHAN) CO., LTD.**  
P/N: 2012-2XxxxxD-L2-L3x-x  
SHEET 1/1 Ver.No. A6