

REV.	SPECIFICATION	ECN NO.	APPD.

**Material:**

Housing: PBT,UL94V-0,Black.  
 Contacts: Brass,Gold Flash over Nickel 30u".  
 Shell: Steel.

**Electrical Characteristics:**

Current Rating: 1 AMP.  
 Dielectric Withstanding Voltage: AC 1000V.  
 Insulator Resistance: 1000MΩ min.  
 Contact Resistance: 30mΩ max.  
 Operating Temperature: -20°C~+70°C.

**\*RoHS Compliant**

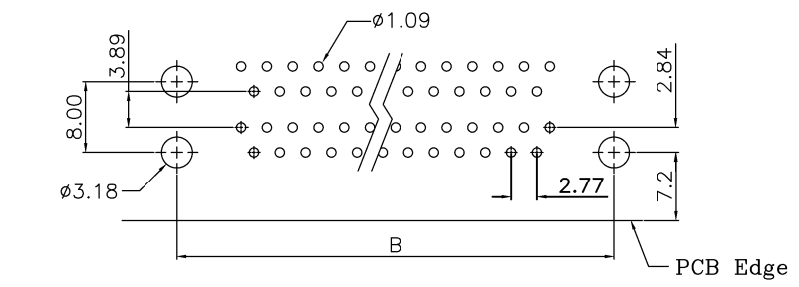
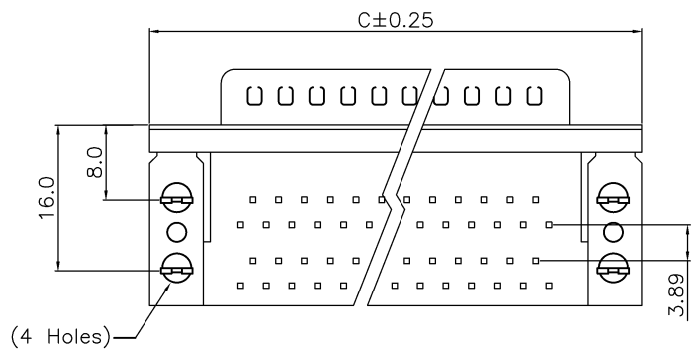
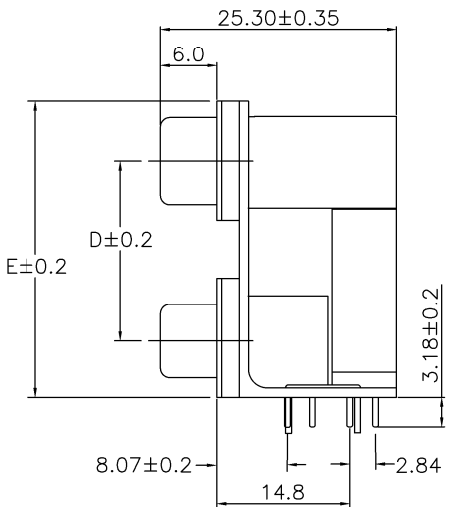
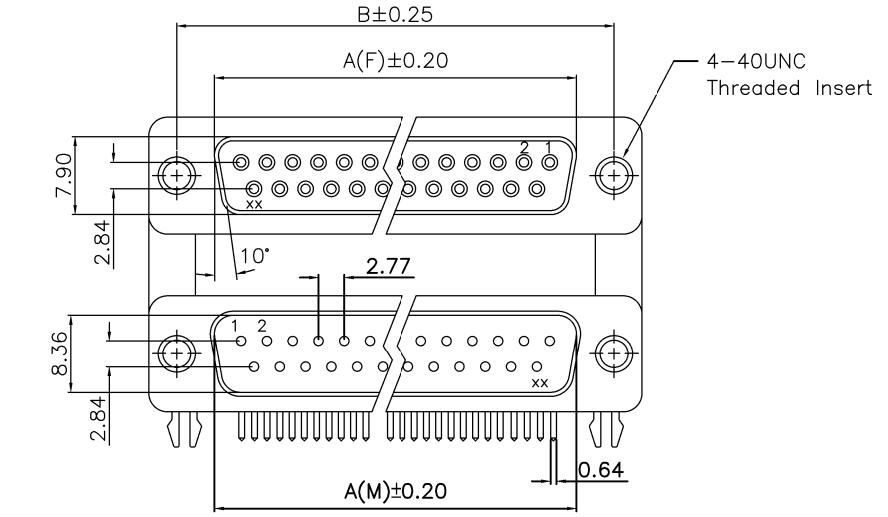
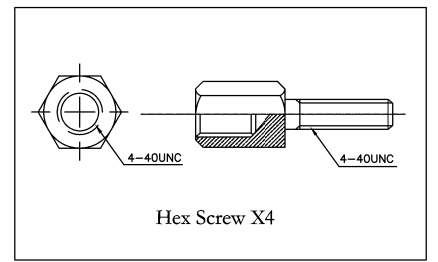

**7936-** xx F M H x A  
 Series Position F: Female M: Male H: Grounding Fork, x: 1:15.88 See Dim:D A:Tary Package  
 Top Bottom Jack Screw Separately 2:19.05 See Dim:D

Position	A(M)	A(F)	B	C	D		E	
9	16.92	16.32	24.99	30.81	15.88	19.05	28.43	31.60
15	25.25	24.66	33.32	39.14	15.88	19.05	28.43	31.60
25	38.96	38.38	47.04	53.04	15.88	19.05	28.43	31.60

<b>Tolerances</b>	<b>Dwg. No.</b>	7936D03022	
x = ±0.50	<b>Projection</b>	⊕ ⊖	
.x = ±0.25	<b>Unit</b>	mm	Scale 1:N
.xx = ±0.15	<b>Drawn By</b>	Martin 09/29'22	

**Title:**  
 7936 Series  
 D-SUB Double Port  
 Right Angle Type  
 Ø512

<b>OUPIIN</b>			
OUPIIN ELECTRONIC(KUNSHAN) CO., LTD.			
P/N: 7936-xxFMHxA			
<b>SHEET</b>	1/1	<b>Ver.No.</b>	A4