

|      |               |         |       |
|------|---------------|---------|-------|
| REV. | SPECIFICATION | ECN NO. | APPD. |
|      |               |         |       |

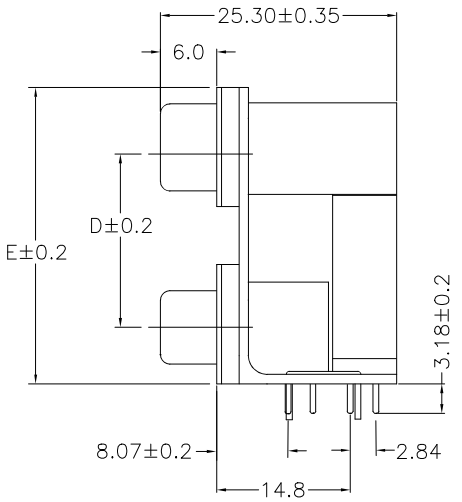
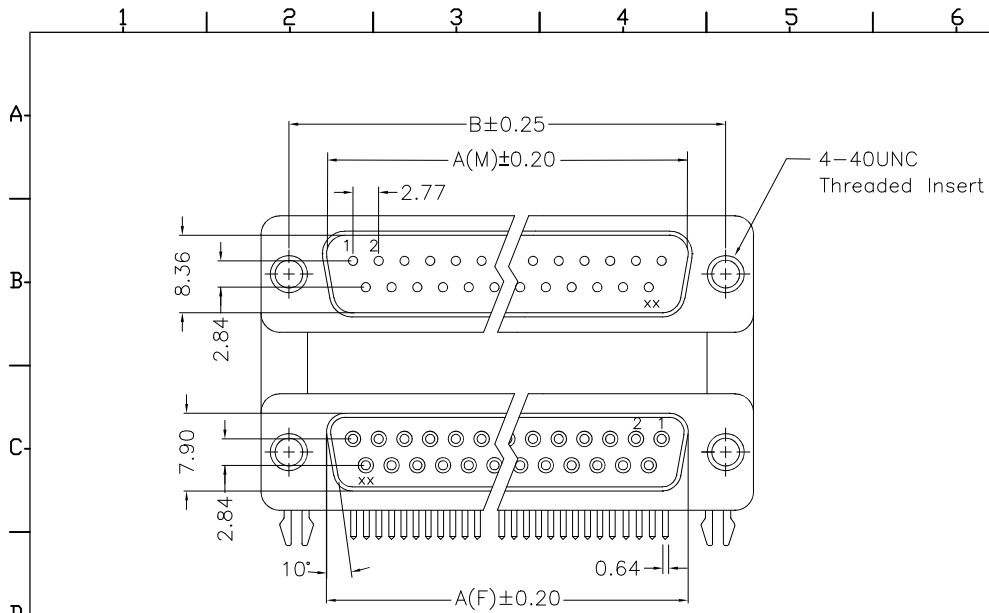

**Material:**  
Housing: PBT, UL94V-0, Black.  
Contacts: Brass, Gold Plated over 30u" Nickel Plated.  
Shell: Steel.

**Electrical Characteristics:**  
Current Rating: 1 AMP.  
Dielectric Withstanding Voltage: AC 1000V.  
Insulator Resistance: 1000MΩ min.  
Contact Resistance: 30mΩ max.  
Operating Temperature: -20°C~+70°C.

**\*RoHS Compliant**

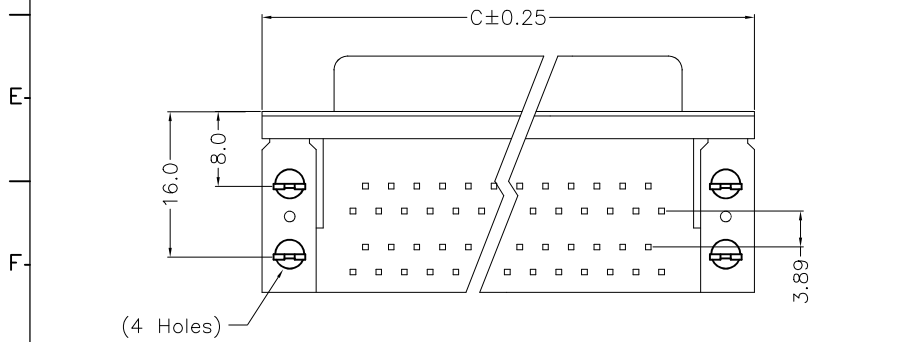
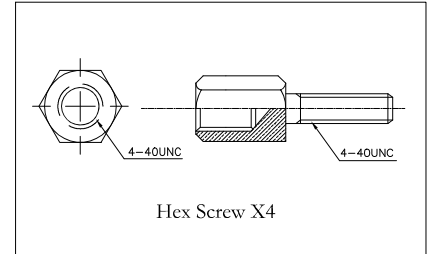

7936-xx M F B x A  
Series Position M: Male Top F: Female Bottom B: Grounding Fork H: Grounding Fork, Jack Screw Separately x: 1:15.88 See Dim:D 2:19.05 See Dim:D A: Tray Package

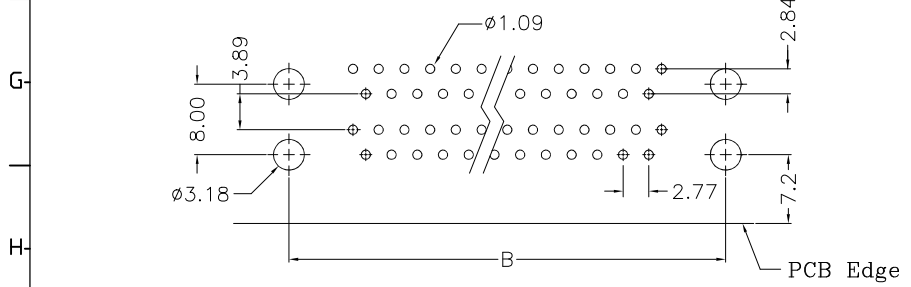

| Position | Dimension |       |       |       |       |       |       |
|----------|-----------|-------|-------|-------|-------|-------|-------|
|          | A         | B     | C     | D     | E     |       |       |
| 9        | 16.32     | 24.99 | 30.81 | 15.88 | 19.05 | 28.43 | 31.60 |
| 15       | 24.66     | 33.32 | 39.14 | 15.88 | 19.05 | 28.43 | 31.60 |
| 25       | 38.38     | 47.04 | 53.04 | 15.88 | 19.05 | 28.43 | 31.60 |

|                   |                   |                 |              |  |                |  |     |
|-------------------|-------------------|-----------------|--------------|--|----------------|--|-----|
| <b>Tolerances</b> | <b>Dwg. No.</b>   | 7936D03010      |              | <b>Title:</b>  |                | <b>OUPIIN</b><br>OUPIIN ELECTRONIC(KUNSHAN) CO., LTD.<br>P/N: 7936-xxMFBxA |     |
| x = ±0.50         | <b>Projection</b> | ⊕ ⊖             |              | 7936 Series<br>D-SUB Double Port<br>Right Angle Type |                |  |     |
| .x = ±0.25        | <b>Unit</b>       | mm              | <b>Scale</b> | 1:1  |                | <b>SHEET</b>   | 1/1 |
| .xx = ±0.15       | <b>Drawn By</b>   | Martin 05/04'23 |              | φ512   | <b>Ver.No.</b> | B1   |     |