

REV.	SPECIFICATION	ECN NO.	APPD.
R6		ECN241242	

Material and Plating:
Housing: PBT, UL94V-0, BLACK
Cover: PBT, UL94V-0, BLACK
Contacts: Brass.
Gold Plated on Contact Area and Gold Flash on solder tail over Nickel 50u" Min.
Or Tin 80u" Min Plated over Nickel 50u" Min.

Electrical Characteristics:
Current Rating: 2 AMP.
Dielectric Withstanding Voltage: AC 1000V For 1 minute.
Insulator Resistance: 1000MΩmin. at DC 500V.
Contact Resistance: 20mΩmax. at DC 100mA.
Operating Temperature: -55°C ~ +105°C.

***RoHS Compliant**
Insertion Depth: 2.55mm to 5.70mm.

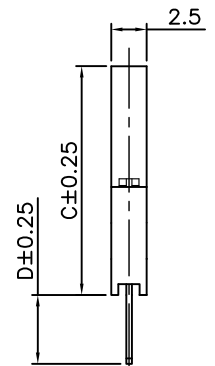
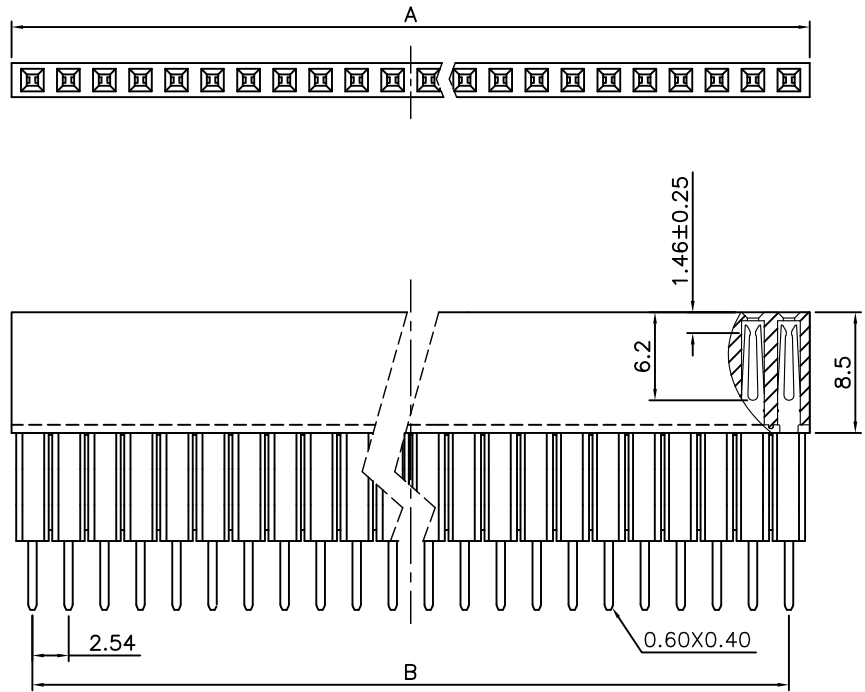
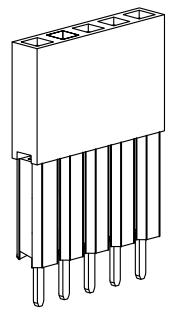

2047- 1 X xx G xx S x U
Series Single Row No. of Pin Per Row
G: Gold Plated T: Tin Plated
U: Tube Package
Choices of Code 1~11
S: Straight
00: G/F
10: 10u"
15: 15u"
30: 30u"

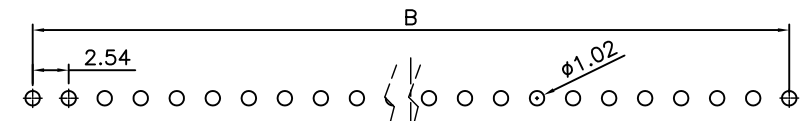

P.C. Board Layout
(Tolerance: ±0.05)

Position	4 Thru 80										
Dimension	2.54 X No. of Positions+0.4										
A	2.54 X No. of Positions+0.4										
B	2.54 X No. of Positions-2.54										
C	1	2	3	4	5	6	7	8	9	10	11
(Code)	11.05	11.05	13.59	16.13	11.05	13.59	16.13	18.67	11.05	18.67	21.21
D	2.50	7.35	4.85	2.30	12.20	9.65	7.10	4.60	3.50	3.00	2.06

Tolerances	Dwg. No.	2047-D0000-002	
x = ±0.5	Projection	⊕ ◁	
.x = ±0.25	Unit	mm	Scale 1:1
.xx = ±0.15	Drawn By	XM 12/23'24	

Title:
2047 Series
Elevated P.C.B. Socket 2.54mm
(0.100")

OUPIN
OUPIN ELECTRONIC(KUNSHAN) CO., LTD.
P/N: 2047-1XxxGxxSxU
SHEET 1/1 Ver.No. R6