

REV.	SPECIFICATION	ECN NO.	APPD.
R8		ECN220843	

Material and Plating:

Housing: LCP, UL94V-0, Black .
 Contacts: Phosphor Bronze.
 Gold Plated on Contact Area and 80u" Min Tin Plated or Gold Flash on Solder Tail over Nickel 50u" Min .

Electrical Characteristics:

Current Rating: 1 AMP.
 Dielectric Withstanding Voltage: AC 500V For 1 minute.
 Insulator Resistance: 1000MΩ min. at DC 500V.
 Contact Resistance: 20mΩmax. at DC 100mA.
 Operating Temperature: -65°C ~ +125°C.

***RoHS Compliant**

Insertion Depth: 1.90mm to 2.90mm

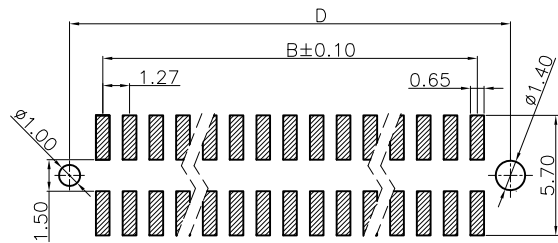
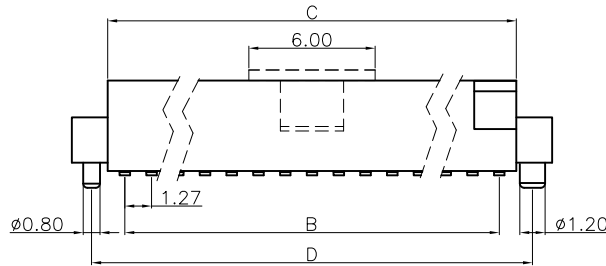
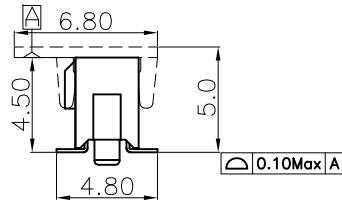
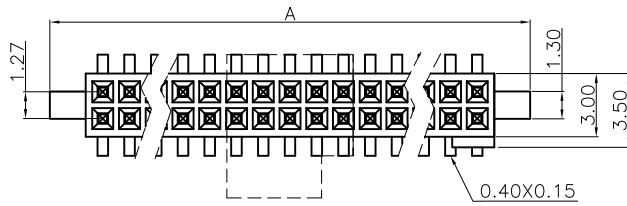
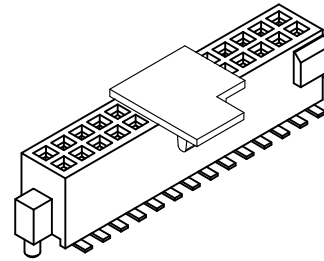

Series: 2243-
 No. of Position: xx
 C: Selective Gold Plated
 G: Gold Plated
 00: G/F
 10: 10μ"
 15: 15μ"
 30: 30μ"
 C xx D P T -P
 P: Plastic Pad
 T: Tape & Reel Package
 U: Tube Package
 P: With Post
 D: Surface Mount

Position	10 Thru 100
Dimension	
A	1.27 X No. of Positions/2 + 3.78
B	1.27 X No. of Positions/2 - 1.27
C	1.27 X No. of Positions/2 + 0.38
D	1.27 X No. of Positions/2 + 1.91

Tolerances	Dwg.No.	2243D02014
x = ±0.50	Projection	
.x = ±0.25	Unit	mm
.xx = ±0.15	Scale	1:1
	Drawn By	CCH8/22/22

Title:
 2243 Series
 P.C.B. Socket
 1.27mmX1.27mm

OUPIN
 OUPIN ELECTRONIC(KUNSHAN) CO., LTD.
 P/N: 2243-xxCxxDPT-P
 SHEET 1/1 Ver. No. R8