

REV.	SPECIFICATION	ECN NO.	APPD.

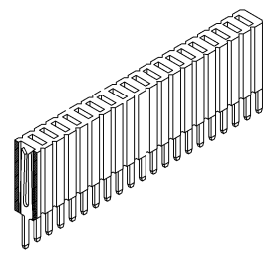
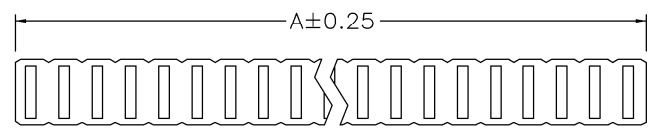

**Material:**

Housing: LCP, UL94V-0.  
 Contacts: Phosphor Bronze. Gold Plated on Contact Area and Gold Flash on solder tail over Nickel 30~50u".

**Electrical Characteristics:**

Current Rating: 1 AMP.  
 Dielectric Withstanding Voltage: AC 300V.  
 Insulator Resistance: 1000MΩ min.  
 Contact Resistance: 20mΩ max.  
 Operating Temperature: -40°C~+105°C.

**\*RoHS Compliant**

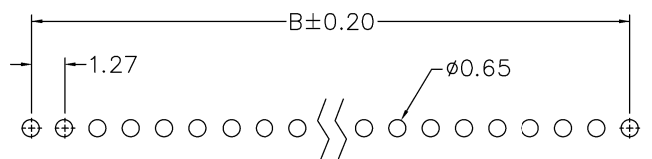
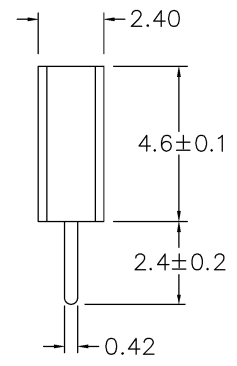
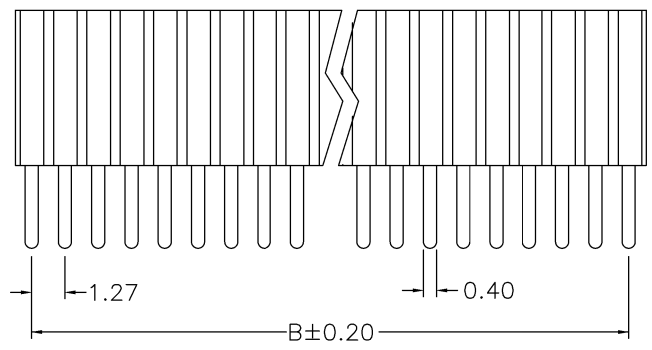

P.C. Board Layout

2244- 1 X xx G 00 S B  
 Series: 2244-  
 Single Row: 1  
 No. of Pin Per Row: X  
 G: Gold Plated  
 00: Gold Flash  
 S: Straight  
 B: Bulk Package  
 U: Tube Package

Positions	Dimension				
	A	B	Positions	A	B
02	2.54	1.27	26	33.02	31.75
03	3.81	2.54	27	34.29	33.02
04	5.08	3.81	28	35.56	34.29
05	6.35	5.08	29	36.83	35.56
06	7.62	6.35	30	38.10	36.83
07	8.89	7.62	31	39.37	38.10
08	10.16	8.89	32	40.64	39.37
09	11.43	10.16	33	41.91	40.64
10	12.70	11.43	34	43.18	41.91
11	13.97	12.70	35	44.45	43.18
12	15.24	13.97	36	45.72	44.45
13	16.51	15.24	37	46.99	45.72
14	17.78	16.51	38	48.26	46.99
15	19.05	17.78	39	49.53	48.26
16	20.32	19.05	40	50.80	49.53
17	21.59	20.32	41	52.07	50.80
18	22.86	21.59	42	53.34	52.07
19	24.13	22.86	43	54.61	53.34
20	25.40	24.13	44	55.88	54.61
21	26.67	25.40	45	57.15	55.88
22	27.94	26.67	46	58.42	57.15
23	29.21	27.94	47	59.69	58.42
24	30.48	29.21	48	60.96	59.69
25	31.75	30.48	49	62.23	60.96
26	33.02	31.75	50	63.50	62.23

Tolerances	Drawn No.	2244D02003	Title:		 <b>OUPIN ELECTRONIC(KUNSHAN) CO., LTD.</b> P/N: 2244-1XxxG00SB SHEET 1/1 Ver.No. A7
x = ±0.50	Projection		2244 Series		
.x = ±0.25	Unit	mm	Scale	1:N	
.xx = ±0.15	Drawn By	Martin 10/25'21	P.C.B Socket 1.27mm		
			719		