

REV.	SPECIFICATION	ECN NO.	APPD.
R2		ECN190431	

Material and Plating:

Housing: LCP,UL94V-0, BLACK.
 Power Contacts: High Conductivity Copper .
 Au+Pd/Ni or Gold Plated on Contact Area and 80u" Min Tin Plated on Solder Tail over Nickel 50u".
 Signal Contacts : Brass .
 Au+Pd/Ni or Gold Plated on Contact Area and 80u" Min Tin Plated on Solder Tail over Nickel 50u".
 Lock: Phosphor Bronze .

Electrical Characteristics:

Current Rating: Signal Pin: 2.5 A.
 Power Pin: 65A(2oz x 6).
 Dielectric Withstanding Voltage:
 Signal Pin DC 1000V For 1 minute.
 Power Pin DC 2500V For 1 minute.
 Insulator Resistance: Signal Pin 500MΩ max.
 Power Pin 1000MΩ max.
 Contact Resistance: Signal Pin 20mΩ max.
 Power Pin 0.7mΩ max.
 Operating Temperature: -40°C ~+125°C .

***RoHS Compliant**

Notes 1 : H: High density Power---PCB Mount 5.08mm Pitch
 P: DC Power---PCB Mount 6.35mm Pitch
 A: AC Power---PCB Mount 7.62mm Pitch
 S: Signal---PCB Mount 2.54mm Pitch
 Notes 2: All Contact Length is 6.86mm.
 Applicable M2 screws.
 Tightening Torque: 0.6 N. m Max.

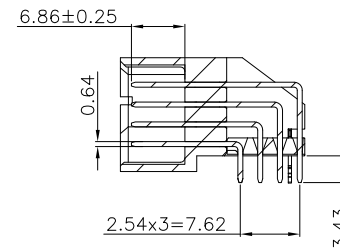
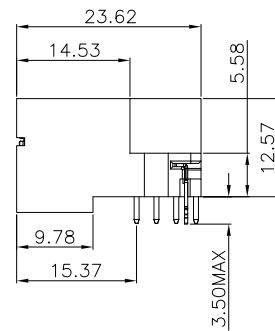
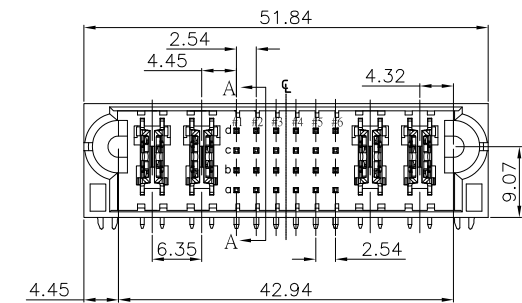
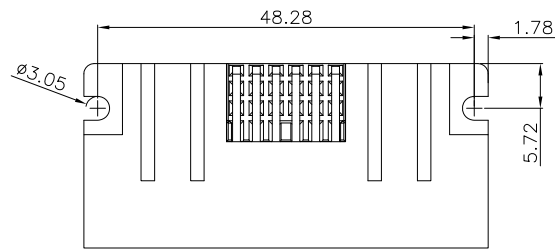

Section: A-A
 Scale:1:1

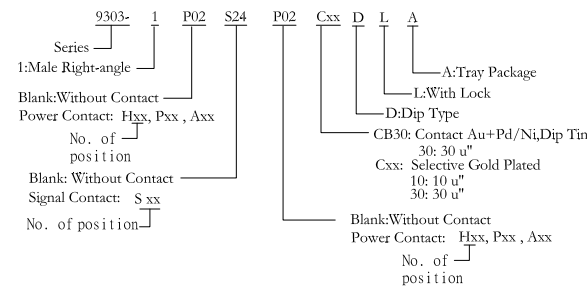
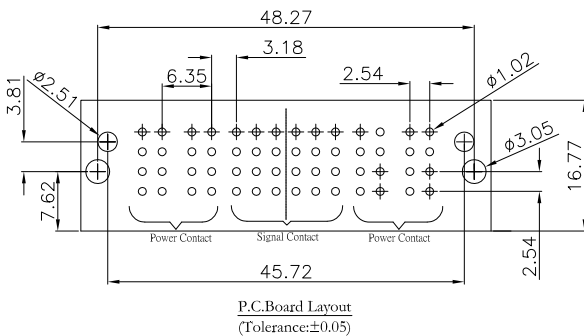

ROWS	POWER		SIGNAL				POWER			
	P1	P2	1	2	3	4	5	6	P3	P4
D	MS	MS	G	G	G	G	G	G	MS	MS
C	MS	MS	G	G	G	G	G	G	MS	MS
B	MS	MS	G	G	G	G	G	G	MS	MS
A	MS	MS	G	G	G	G	G	G	MS	MS

SIGNAL PIN CONTACT LENGTH 4.32mm	H
SIGNAL PIN CONTACT LENGTH 5.59mm	E
SIGNAL PIN CONTACT LENGTH 7.05mm	F
SIGNAL PIN CONTACT LENGTH 6.86mm	G
HOT PLUG POWER CONTACT.STD	MS

Tolerances	Dwg. No.	9303-D0000-027	Title:	9303 Series	 OUPIN ELECTRONIC(KUNSHAN) CO., LTD. P/N: 9303-1P02S24P02CB30DLA
x = ±0.5	Projection		Male Right-angle Dip Type	SHEET	
.x = ±0.25	Unit	mm	Scale	1:1	
.xx = ±0.15	Drawn By	CXP 04/11'19	Ver. No.	R2	