

REV.	SPECIFICATION	ECN NO.	APPD.
R4		ECN220534	

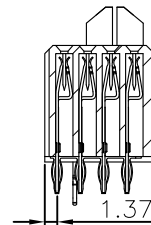

Section: A-A
Scale: 1:1

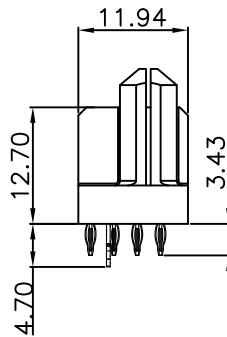
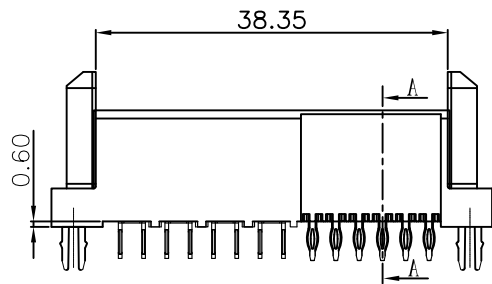
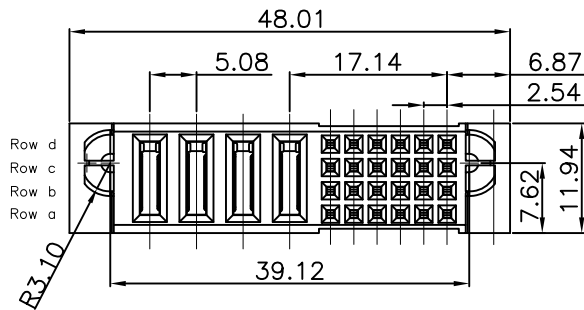
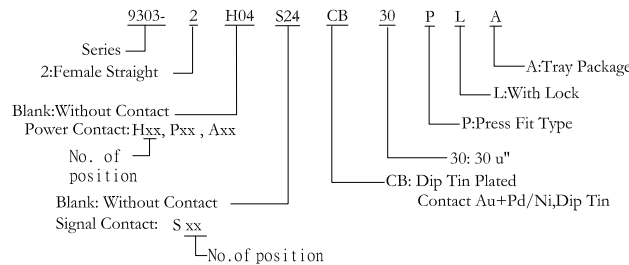
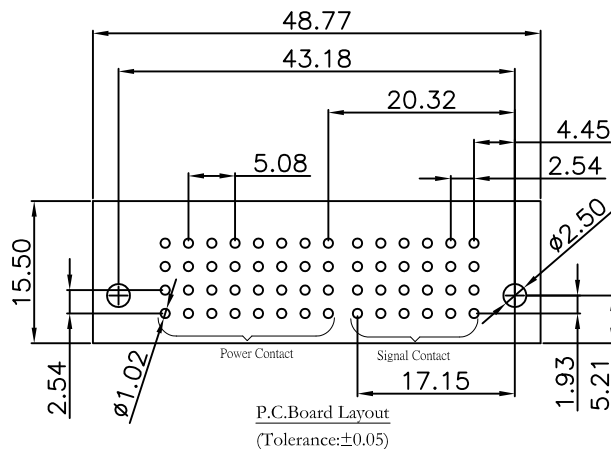

Material and Plating:

Housing: LCP, UL94V-0 , Black.

Power Contacts: High Conductivity Copper.
30u" Au+Pd/Ni on Contact Area and 80u" Min Tin Plated on Press Fit over 50u" Min Nickel.

Signal Contacts : Phosphor Bronze.

30u" Au+Pd/Ni on Contact Area and 80u" Min Tin Plated on Press Fit over 50u" Min Nickel.

Lock: Phosphor Bronze.

Electrical Characteristics:

Current Rating: Signal Pin: 2.5 A.

Power Pin: 90A Single Port (UL)(2oz x 6).

Dielectric Withstanding Voltage:

Signal Pin DC 1000V For 1 minute.

Power Pin DC 2500V For 1 minute.

Insulator Resistance: Signal Pin 500MΩ max.

Power Pin 1000MΩ max.

Contact Resistance: Signal Pin 20mΩ max.

Power Pin 0.7mΩ max.

Operating Temperature: -40°C ~+125°C .

*RoHS Compliant

Notes :

- H: High density Power---PCB Mount 5.08mm Pitch
- P: DC Power---PCB Mount 6.35mm Pitch
- A: AC Power---PCB Mount 7.62mm Pitch
- S: Signal---PCB Mount 2.54mm Pitch

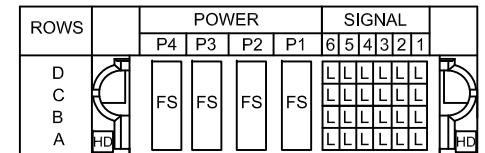

POWER CONTACT TO THE TOP DISTANCE 1.78mm, THE MATING LENGTH 4.43mm	FS
SIGNAL CONTACT 3.43 SOLDER TAIL, PD/Ni	L

Tolerances	Dwg. No.	9303-D0000-011		Title:	9303 Series			
x = ±0.5	Projection	⊕		Female Straight Press Fit Type	 OUPIIN ELECTRONIC(KUNSHAN) CO., LTD. P/N: 9303-2H04S24CB30PLA			
.x = ±0.25	Unit	mm	Scale					
.xx = ±0.15	Drawn By	XS 05/15'22			SHEET	1/1	Ver. No.	R4