

REV.	SPECIFICATION	ECN NO.	APPD.
R8		ECN150426	

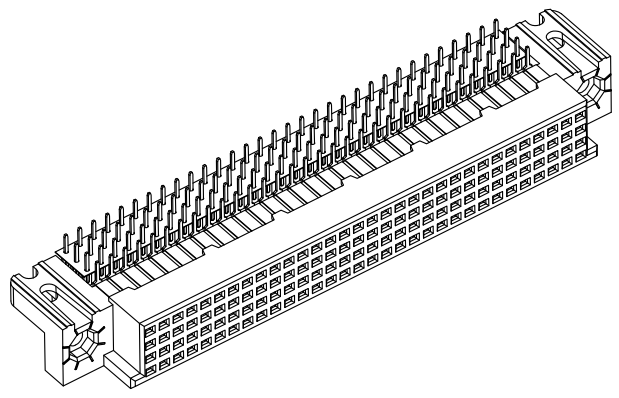
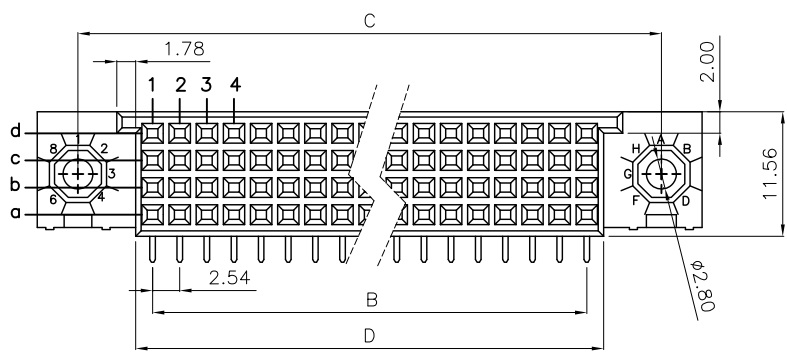

Material:

Housing: High Temperature Plastic UL94V-0

Contacts: Copper Alloy

Electrical Characteristics:

Current Rating: 2 AMP.

Dielectric Withstanding Voltage: AC 1000V For 1 minute.

Insulator Resistance: 1000M Ω min. at DC 500V.

Contact Resistance: 20m Ω max. at DC 100mA.

Operating Temperature: -55 $^{\circ}$ C ~+125 $^{\circ}$ C .

***RoHS Compliant**

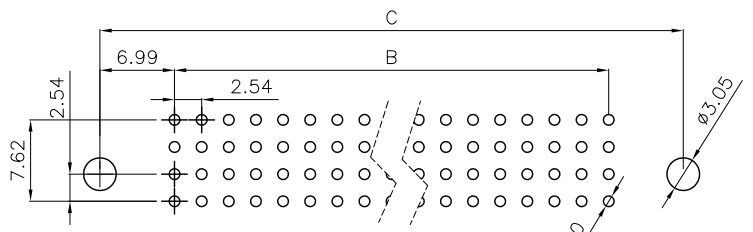
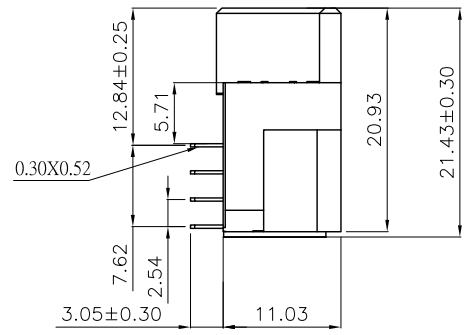
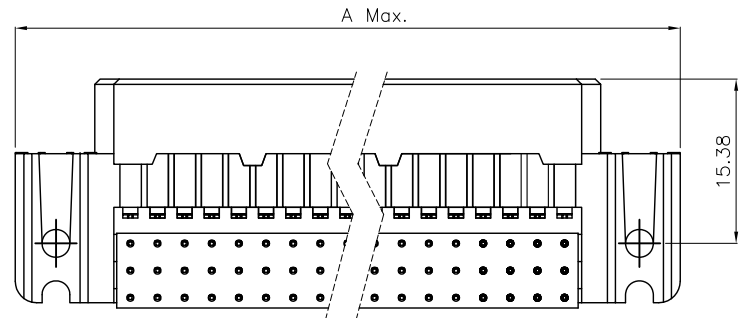

P.C. Board Layout
(Tolerance: ± 0.05)

9001- 7 4 xx 1 C xx A
 Series 7:2.54mm 4:Female 1:Dip Length C:Dip Tin Contact Gold G:Gold Plated
 Position A:Tray Package
 00:G/F
 10:10u"
 15:15u"
 30:30u"

Position	Dimension			
	A	B	C	D
100	82.55	60.96	74.93	64.12
128	100.33	78.74	92.71	81.90
160	120.65	99.06	113.03	102.22
200	146.05	124.46	138.43	127.62
220	158.75	137.16	151.13	140.32
240	171.45	149.86	163.83	153.02

Tolerances	Dwg. No.	9001D74001	Title:	9001 Series DIN41612 Female Right Angle
x = ± 0.5	Projection			
.x = ± 0.25	Unit	mm		
.xx = ± 0.15	Scale	1:1		
	Drawn By	Y W 4/22'15		

OUPIN
 OUPIN ELECTRONIC(KUNSHAN) CO., LTD.
 P/N: 9001-74xx1CxxA
 SHEET 1/1 Ver.No. R8