

REV.	SPECIFICATION	ECN NO.	APPD.
R5		ECN170528	

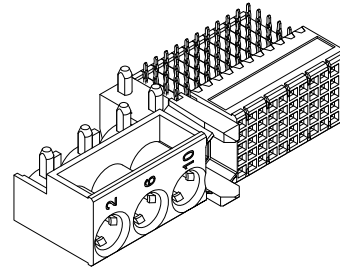
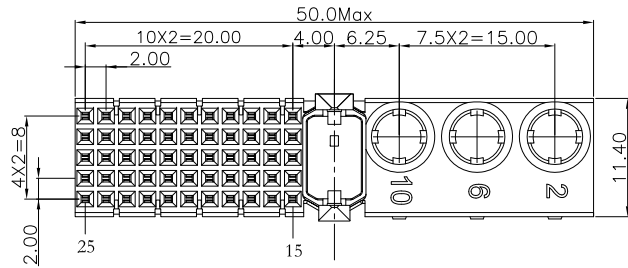

Material:

Housing: Thermoplastic Polyester Glass Filled UL94V-0.

Contacts: Copper Alloy

Electrical Characteristics:

Current Rating: 1 AMP.

Dielectric Withstanding Voltage: AC 750V For 1 minute.

Insulator Resistance: 10000MΩ min. at DC 500V.

Contact Resistance: 20mΩ max. at DC 100mA.

Operating Temperature: -55°C ~+125°C .

***RoHS Compliant**

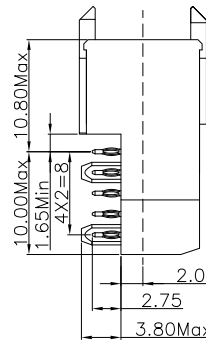
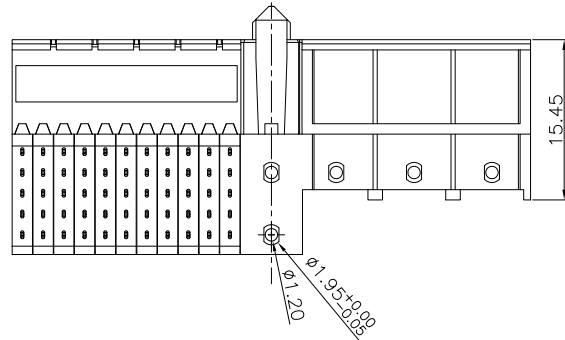

None Shielded

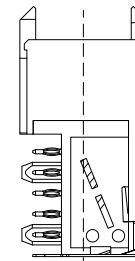

With Top Body Shielded

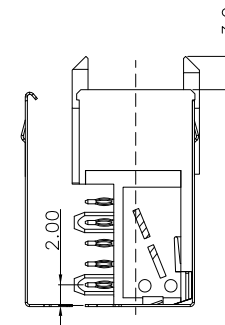

With Top Body Shielded and Bottom Shielded

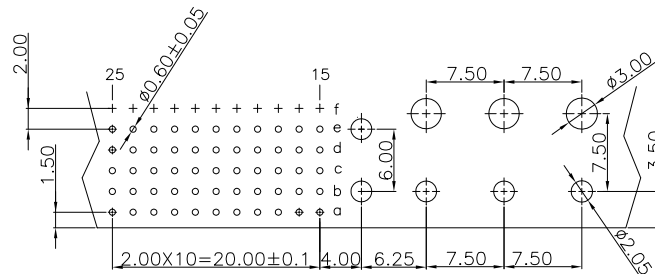

P.C. Board Layout for Power Contact

(Tolerance:±0.05)

(Top View)

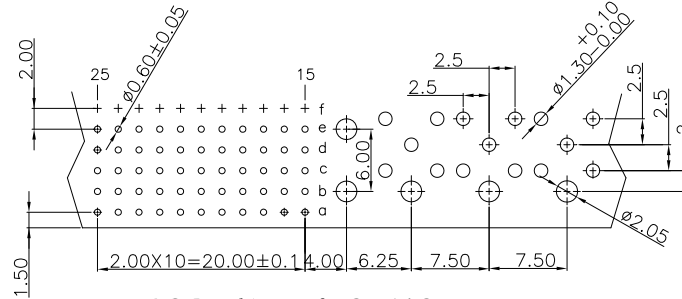

P.C. Board Layout for Coaxial Contact

(Tolerance:±0.05)

(Top View)

Series	7Row	2: Female	M: Type M	55 Signal+3Cavities	1: None Shielded	2: Top Body Shielded	3: Top Body Shielded and Bottom Shielded (Package Separately)	U: Tube Package	Cxx: Dip Tin Contact Gold	10: 10u"	30: 30u"	CB30: Dip Tin Contact Au+Pd/Ni	30: 30u"
--------	------	-----------	-----------	---------------------	------------------	----------------------	---	-----------------	---------------------------	----------	----------	--------------------------------	----------

Tolerances	Dwg. No.	9111D72020		Title:	9111 Series Hard Metric Connector Female Right Angle Type M			
x = ±0.5	Projection	⊕		P/N: 9111-72MxCxxU	SHEET	1/1	Ver.No.	
.x = ±0.25	Unit	mm	Scale					R5
.xx = ±0.15	Drawn By	LQ 05/17'17						



OUPIN ELECTRONIC(KUNSHAN) CO., LTD.

P/N: 9111-72MxCxxU

SHEET 1/1 Ver.No. R5