

REV.	SPECIFICATION	ECN NO.	APPD.
R2		ECN160452	

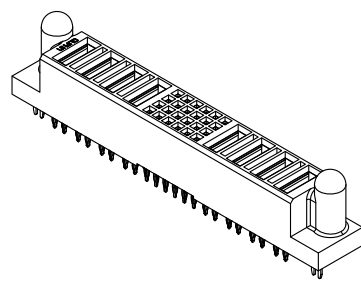

Material:
Housing: High Temperature Plastic UL94V-0 .
Contacts: Copper Alloy
Lock: Copper Alloy

Electrical Characteristics:
Current Rating: Signal Pin 2.5 AMP.
 Power Pin 30 AMP.
Dielectric Withstanding Voltage:
 Signal Pin DC 1000V For 1 minute.
 Power Pin DC 2500V For 1 minute.
Insulator Resistance: Signal Pin 5000MΩ min. at DC 500V.
 Power Pin 20000MΩ min. at DC 500V.
Contact Resistance: Signal Pin 15mΩ max. at DC 20mA.
 Power Pin 0.7mΩ max. at DC 20mA.
Operating Temperature: -40°C ~+105°C .

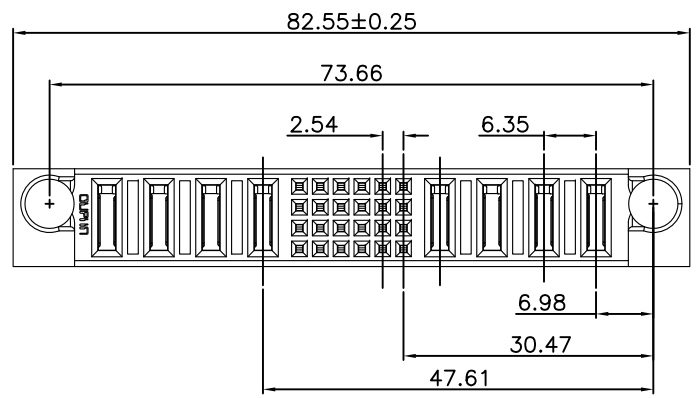
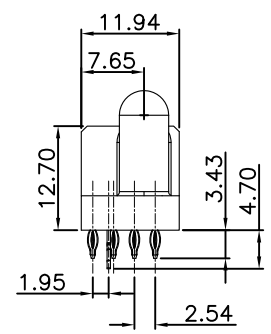
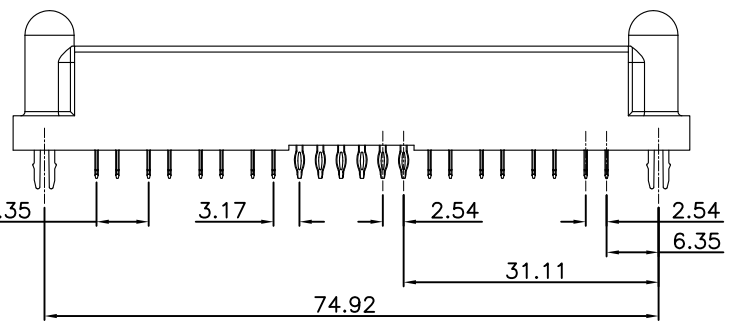

***RoHS Compliant**

Notes :
 H: High density Power---PCB Mount 5.08mm Pitch
 P: DC Power---PCB Mount 6.35mm Pitch
 A: AC Power---PCB Mount 7.62mm Pitch
 S: Signal---PCB Mount 2.54mm Pitch

ROWS	Left POWER				SIGNAL				Right POWER					
	P1-P6				6	5	4	3	2	1	P1-P6			
D					L	L	L	L	L	L				
C					L	L	L	L	L	L				
B					L	L	L	L	L	L				
A					L	L	L	L	L	L				

POWER CONTACT TO THE TOP DISTANCE 2.34mm, THE MATING LENGTH 3.87mm	FM
POWER CONTACT TO THE TOP DISTANCE 1.07mm, THE MATING LENGTH 5.14mm	FS
SIGNAL CONTACT 3.43 SOLDER TAIL, PD/NI	L

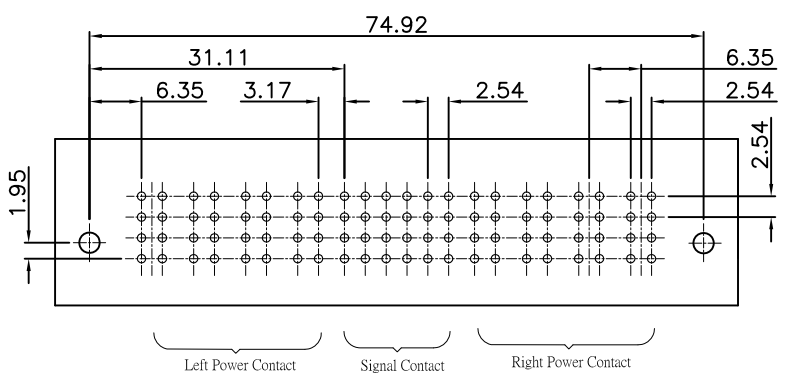

P.C.Board Layout
(Tolerance:±0.05)

9391-A 2 P04 S24 P04 CB 30 P L A
 Series | 2: Female Straight | P04 | S24 | P04 | CB: Dip Tin Plated | 30:30u" | P: Press-Fit Type | L: With Lock | A: Tray Package
 Blank: Without Contact | Contact Au+Pd/Ni Plated | Blank: Without Lock
 Power Contact: Hxx, Pxx, Axx | Contact Au+Pd/Ni Plated | Power Contact: Hxx, Pxx, Axx
 No. of position | xx | No. of position | No. of position

Tolerances	Dwg. No.	9391-D0000-035	Title:		9391 Series			
x = ±0.5	Projection		Female Straight Press Fit Type		 OUPIIN ELECTRONIC(KUNSHAN) CO., LTD. P/N: 9391-A2P04S24P04CB30PLA			
.x = ±0.25	Unit	mm	Scale	1:1				
.xx = ±0.15	Drawn By	zbs 05/20'16			SHEET	1/1	Ver. No.	R2