

REV.	SPECIFICATION	ECN NO.	APPD.
R4		ECN231001	

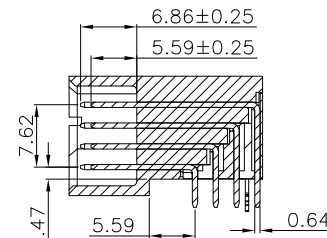

Section:A-A  
Scale:1:1

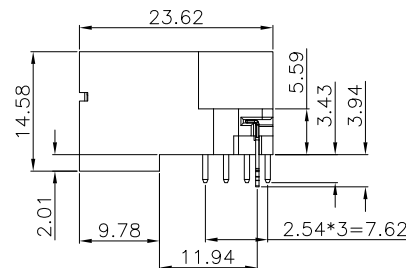
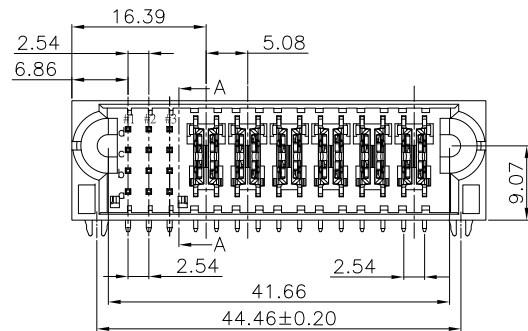
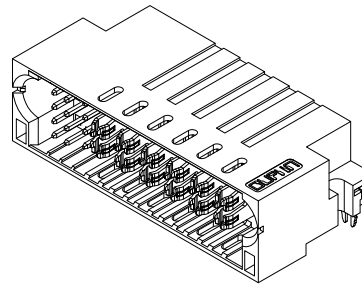
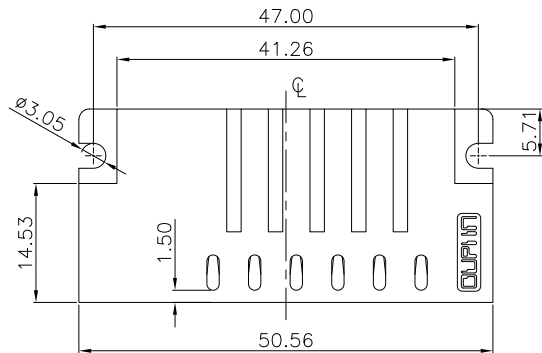
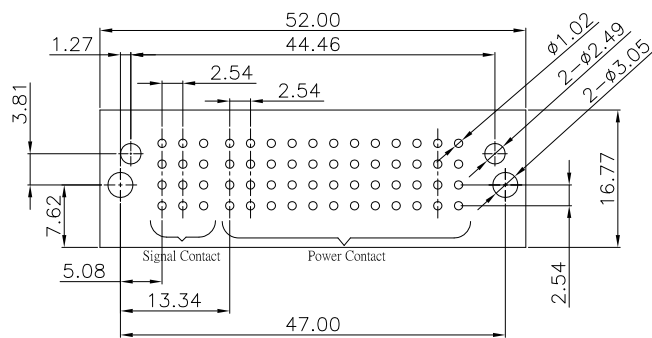

P.C.Board Layout  
(Tolerance:±0.05)

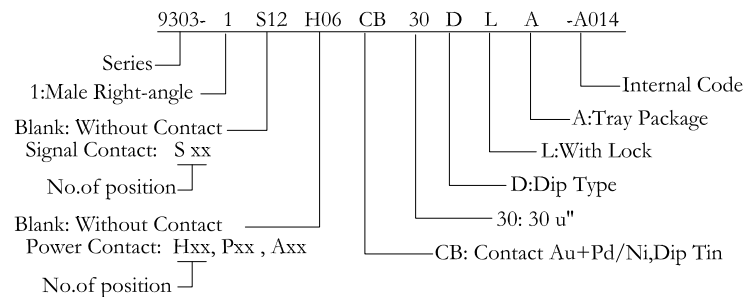

### Material and Plating:

**Housing:** LCP, UL94V-0 , Black.

**Power Contacts:** High Conductivity Copper.  
30u"Au+Pd/Ni on Contact Area and 80u" Min Tin Plated on Solder Tail over nickel 50u" Min .

**Signal Contacts :** Brass  
30u"Au+Pd/Ni on Contact Area and 80u" Min Tin Plated on Solder Tail over nickel 50u" Min .

**Lock:** Phosphor Bronze.

### Electrical Characteristics:

**Current Rating:** Signal Pin: 2.5 A.

Power Pin: 65A.(UL)(2oz x 6).

**Dielectric Withstanding Voltage:**

Signal Pin DC 1000V For 1 minute.

Power Pin DC 2500V For 1 minute.

**Insulator Resistance:** Signal Pin 500MΩ max.

Power Pin 1000MΩ max.

**Contact Resistance:** Signal Pin 20mΩ max.

Power Pin 10mΩ max.

**Operating Temperature:** -40°C ~+125°C .

### \*RoHS Compliant

Notes 1 :

H: High density Power---PCB Mount 5.08mm Pitch

P: DC Power---PCB Mount 6.35mm Pitch

A: AC Power---PCB Mount 7.62mm Pitch

S: Signal---PCB Mount 2.54mm Pitch

Notes 2 :

A3,B3,C3,D3 Contact Length is 5.59mm.

Other Pin Contact Length is 6.86mm.

ROWS	SIGNAL			POWER			H			
	1	2	3	P1	P2	P3		P4	P5	P6
D	G	G	E	MS	MS	MS	MS	MS	MS	H
C	G	G	E	MS	MS	MS	MS	MS	MS	E
B	G	G	E	MS	MS	MS	MS	MS	MS	F
A	G	G	E	MS	MS	MS	MS	MS	MS	G
SIGNAL PIN CONTACT LENGTH 4.32mm									H	
SIGNAL PIN CONTACT LENGTH 5.59mm									E	
SIGNAL PIN CONTACT LENGTH 7.05mm									F	
SIGNAL PIN CONTACT LENGTH 6.86mm									G	
HOT PLUG POWER CONTACT.STD									MS	

Tolerances	Dwg. No.	9303-D0000-076		Title:	
x = ±0.5	Projection	⊕ ⊖		9303 Series Male Right-angle Dip Type	
.x = ±0.25	Unit	mm	Scale		1:1
.xx = ±0.15	Drawn By	XS 10/11'23			

<b>OUPIIN</b>			
OUPIIN ELECTRONIC(KUNSHAN) CO., LTD.			
P/N: 9303-1S12H06CB30DLA-A014			
SHEET	1/1	Ver. No.	R4