

REV.	SPECIFICATION	ECN NO.	APPD.
X7			

**Material and Plating:**

Housing: LCP, 30% Glass Filled, UL94V-0, BLACK.  
 Power Contacts: High Conductivity Copper .  
 30u" Au+Pd/Ni on Contact Area and 80u" Min Tin Plated on Solder Tail over nickel 50u" Min under plated .

**Electrical Characteristics:**

Current Rating: 12.5 A(UL).  
 Dielectric Withstanding Voltage: DC 1000V For 1 minute.  
 Insulator Resistance: 5000MΩ min. at DC 500V.  
 Contact Resistance: 2.5mΩ max. at DC 100mA.  
 Operating Temperature: -5°C ~+105°C .

**\*RoHS Compliant**

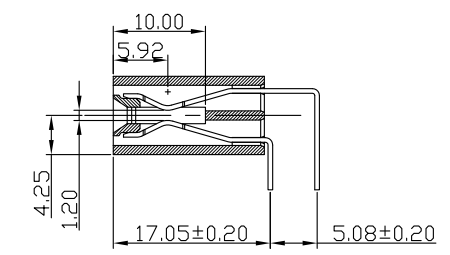
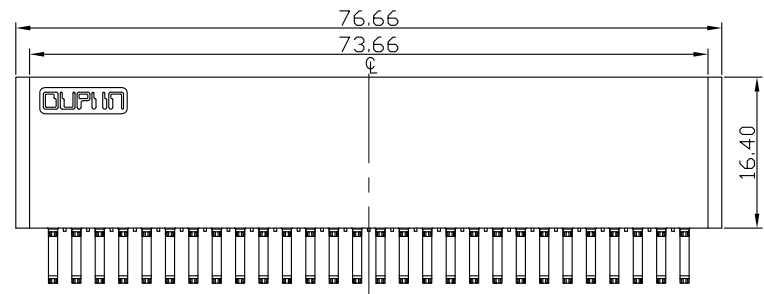
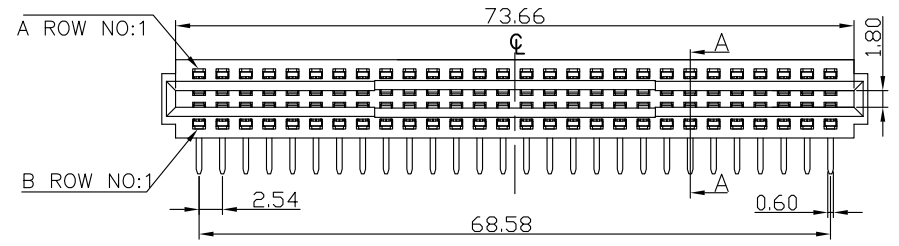
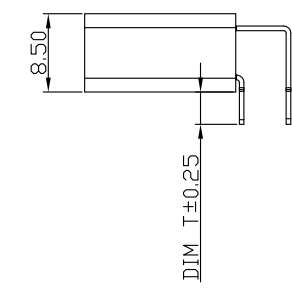
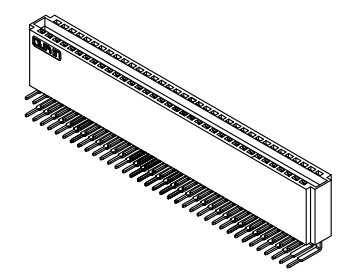

SECTION A-A

- 9393-F 4 P56 N 1 1 A CB30 D A
- Series
- 4:Female Right Angle
- Position
- N:W/O Post
- 1:DIM T=3.5mm
- 2:DIM T=2.6mm
- 1:DIM G(GAP)=1.2mm
- A: Tray Package
- D:Dip Type
- P:Press-Fit Type
- CB30:Contact Au+Pd/Ni,Dip Tin 30u"
- A:Power pitch 2.54
- B:Power pitch 5.08

Tolerances	Dwg. No.	9393-D0000-012	Title:		 <b>OUPIIN ELECTRONIC(KUNSHAN) CO., LTD.</b> <b>P/N: 9393-F4P56N11ACB30DA</b>
x = ±0.5	Projection		9393-F Series		
.x = ±0.25	Unit	mm	Scale	1:1	
.xx = ±0.15	Drawn By	LQ12/26'16			SHEET
					1/2
					Ver. No.
					X7

REV.	SPECIFICATION	ECN NO.	APPD.
X7			

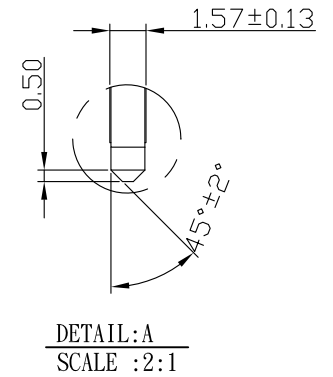
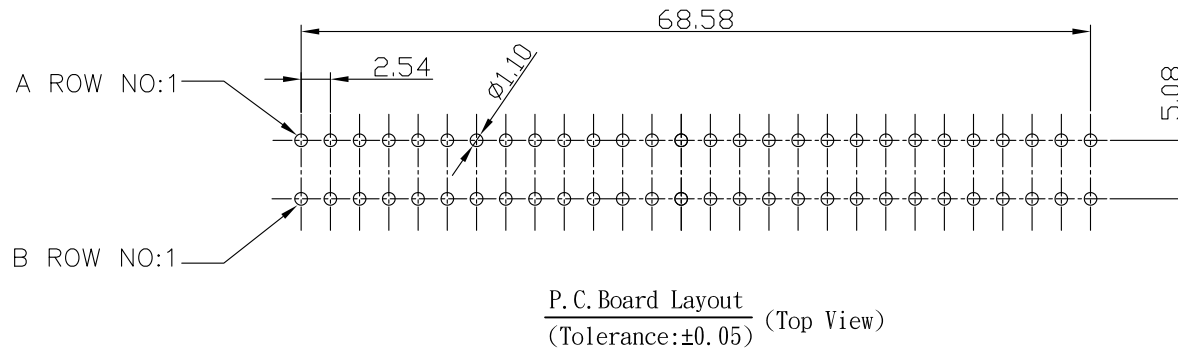
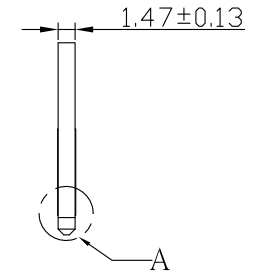
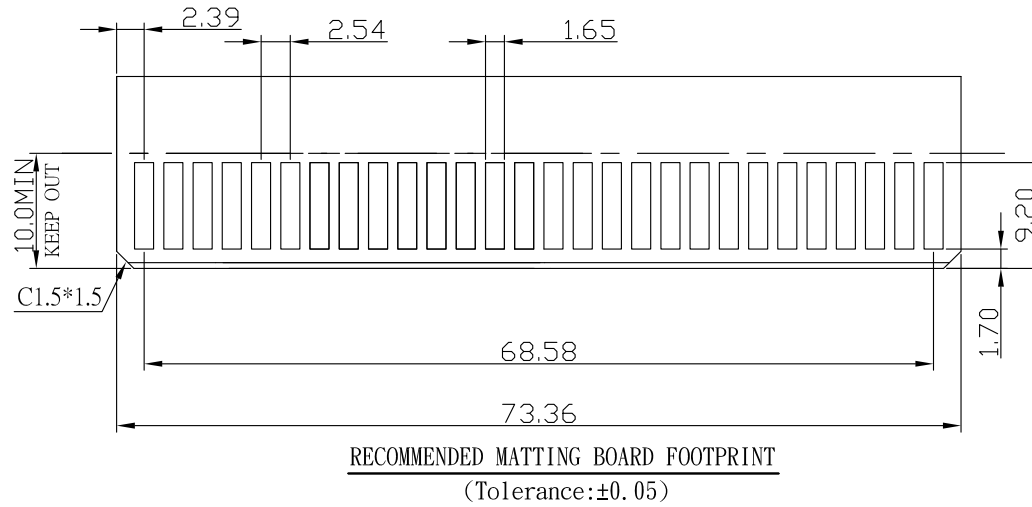

Tolerances	Dwg. No.	9393-D0000-012		Title:		
x = ±0.5	Projection	⊕		9393-F Series Power Edge Connector		
.x = ±0.25	Unit	mm	Scale			1:1
.xx = ±0.15	Drawn By	LQ12/26'16				

<b>OUPIN</b>			
OUPIN ELECTRONIC(KUNSHAN) CO., LTD.			
P/N: 9393-F4P56N11ACB30DA			
SHEET	2/2	Ver. No.	X7