

REV.	SPECIFICATION	ECN NO.	APPD.

Material:
Housing: PA66, UL94V-0.
Contacts: Brass, Tin Plated.
Electrical Characteristics:
Voltage Rating: 300V
Current Rating: 15 AMP.
Dielectric Withstanding Voltage: 1.6KV.
Operating Temperature: -40°C~+115°C.
***RoHS Compliant**

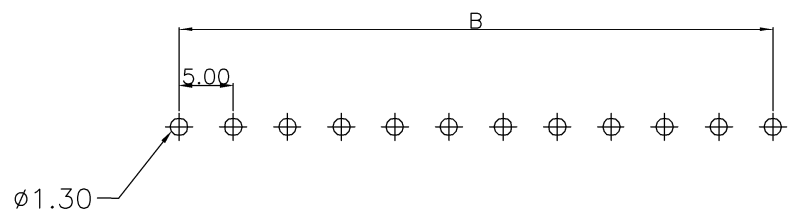
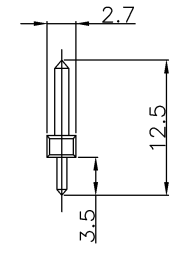
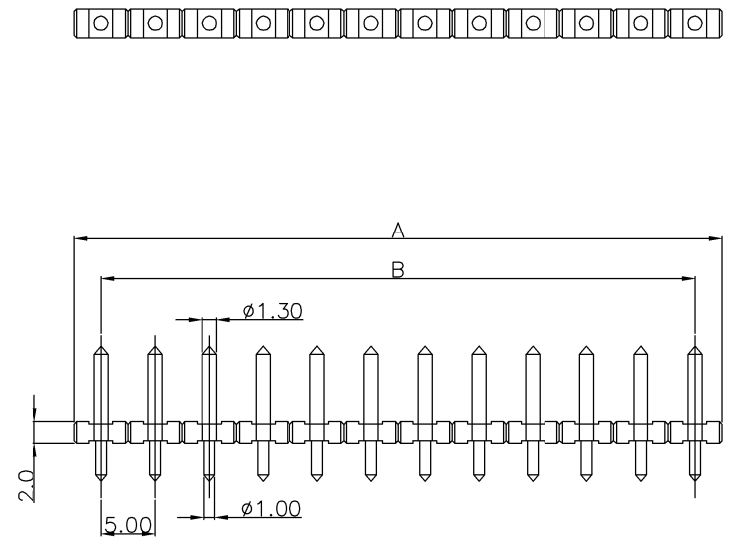

P.C.Board Layout

8930- F 035070 B xx S B -1
Series F:Pitch 5.0mm Manufacturing Code B:Black
S:Straight No. of Positions
Contact OD 1.3 Solder OD 1.0 B:Bulk Package

Tolerance	Positions	Dimension	
		A	B
±0.10	02	10.00	5.00
	03	15.00	10.00
	04	20.00	15.00
	05	25.00	20.00
±0.15	06	30.00	25.00
	07	35.00	30.00
	08	40.00	35.00
	09	45.00	40.00
±0.20	10	50.00	45.00
	11	55.00	50.00
	12	60.00	55.00
	13	65.00	60.00
±0.25	14	70.00	65.00
	15	75.00	70.00
	16	80.00	75.00
	17	85.00	80.00
±0.30	18	90.00	85.00
	19	95.00	90.00
	20	100.00	95.00
	21	105.00	100.00
±0.40	22	110.00	105.00
	23	115.00	110.00
	24	120.00	115.00

Tolerances	Dwg. No.	8930D01033	Title:		8930 Series 5.0mm Terminal Black	 OUPIN ELECTRONIC(KUNSHAN) CO., LTD. P/N: 8930-F035070BxxSB-1			
x. = ±0.50	Projection			SHEET			1/1	Ver.No.	A1
.x = ±0.30	Unit	mm	Scale						
.xx = ±0.10	Drawn By	Martin	06/23'22	676					