

REV.	SPECIFICATION	ECN NO.	APPD.
R5		ECN211029	

Material and Plating:

Housing: LCP, UL94V-0, Black.
 Contacts: Phosphor Bronze.
 Gold Plated on Contact Area and 80u" Min Tin or Gold Flash Plated on Solder Tail over 50u" Min Nickel.

Electrical Characteristics:

Current Rating: 1 AMP.
 Dielectric Withstanding Voltage: AC 500V For 1 minute.
 Insulator Resistance: 1000MΩ min. at DC 500V.
 Contact Resistance: 20mΩmax. at DC 100mA.
 Operating Temperature: -65°C ~ +125°C.

***RoHS Compliant**

Insertion Depth: 1.90mm to 2.90mm

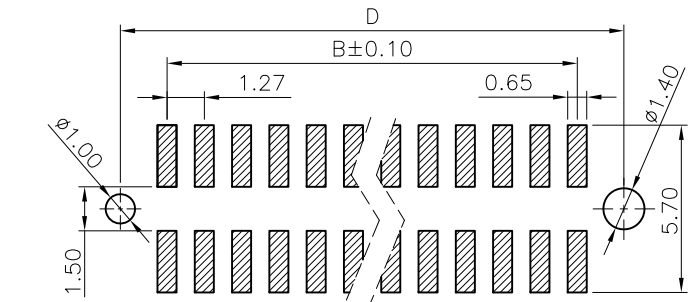
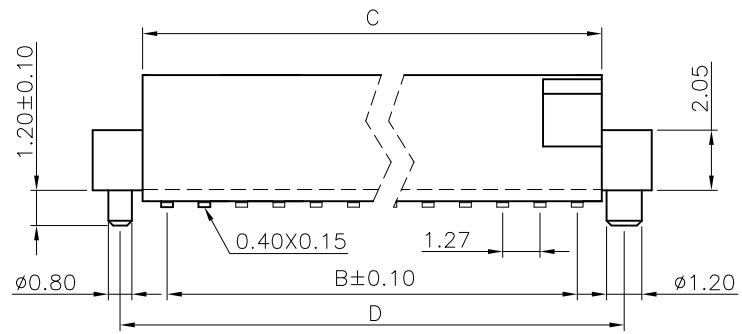
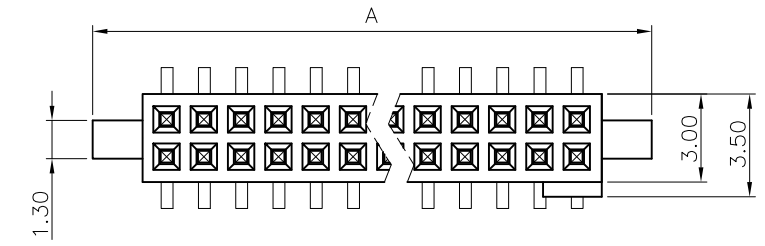
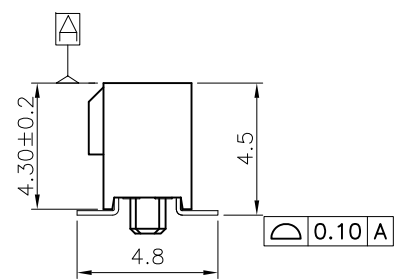
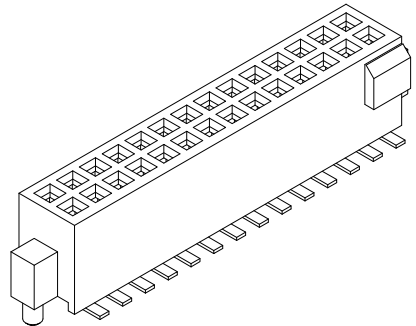

P.C.Board Layout
 (Tolerance: ±0.05mm)

2243- xx C xx D P U
 Series: 2243-
 No. of Position: xx
 C: Selective
 Gold Plated
 G: Gold Plated
 D: Surface Mount
 P: With Post
 U: Tube Package
 00: G/F
 10: 10 μ"
 15: 15 μ"
 30: 30 μ"

Position	10 Thru 100
Dimension	
A	1.27 X No. of Positions/2 +3.78
B	1.27 X No. of Positions/2 -1.27
C	1.27 X No. of Positions/2 +0.38
D	1.27 X No. of Positions/2 +1.91

Tolerances	Dwg.No.	2243D02002
x = ±0.5	Projection	
.x = ±0.25	Unit	mm
.xx = ±0.15	Scale	1:1
	Drawn By	ZY 10/20'21

Title: 2243 Series
 P.C.B. Socket
 1.27mmX1.27mm

OUPIN ELECTRONIC(KUNSHAN) CO., LTD.			
P/N: 2243-xxCxxDPU			
SHEET	1/1	Ver.No.	R5