

REV.	SPECIFICATION	ECN NO.	APPD.

Material:

Housing: Thermoplastic Polyester UL94V-2.
 Contacts: Copper Alloy.

Electrical Characteristics:

Current Rating:

Circuits	2~3	4~6	7~10	11~12
Ampere	9 A	8 A	7 A	6 A

Dielectric Withstanding Voltage: AC 1500V For 1 minute.
 Insulator Resistance: 1000MΩ min. at DC 250V.
 Contact Resistance: 10mΩ max. at DC 100mA.
 Operating Temperature: -40°C~+105°C.

***RoHS Compliant**

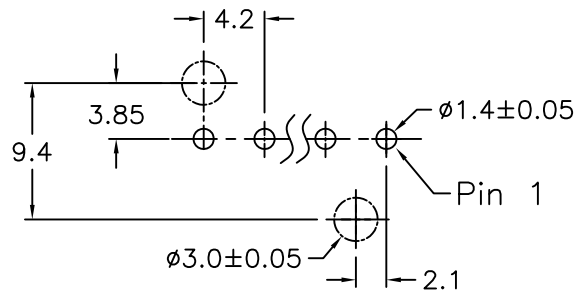
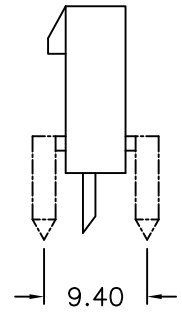
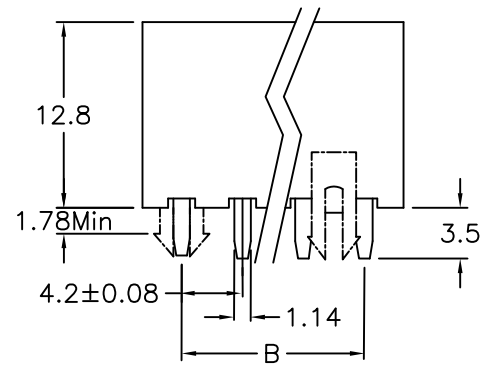
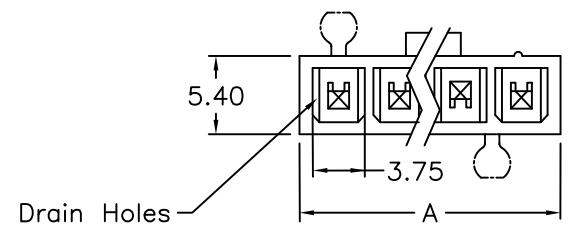

P.C. Board Layout
 (Recommended Thickness 1.78mm Max.)

4973- 1 X xx T S x B
 Series Single No.of T: Tin S: Straight **P: With Post B: Bulk
 Row Position Plated Blank: Without Post Package

**P: With Post Available from 3 to 12 Position.

Position	Dimension	
	A	B
2	9.6	4.2
3	13.8	8.4
4	18.0	12.6
5	22.2	16.8
6	26.4	21.0
7	30.6	25.2
8	34.8	29.4
9	39.0	33.6
10	43.2	37.8
11	47.4	42.0
12	51.6	46.2

Tolerances x = ±0.5 .x = ±0.25 .xx = ±0.15	Dwg. No.	4973D02010	Title: 4973 Series 4.2mm Connector Straight Wafer	 OUPIIN ELECTRONIC(KUNSHAN) CO., LTD. P/N: 4973-1XxxTSxB			
	Projection						
	Unit	mm		Scale	1:1	Drawn By	Scott 06/23'16