

REV.	SPECIFICATION	ECN NO.	APPD.

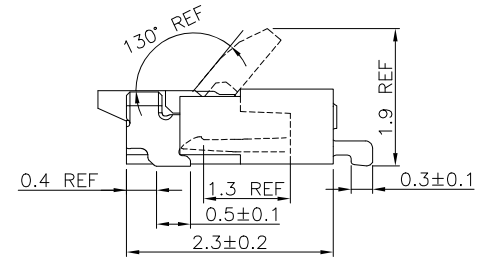

Material:
Housing:LCP, UI94V-0, Natural.
Cover:LCP, UI94V-0, Black.
Contacts: Phosphor Bronze, Gold Plated on Contact Area and Gold Flash on solder tail over Nickel 60u".
Solder Pin: Phosphor Bronze, 80u" Tin Plated over Nickel 60u".
Electrical Characteristics:
Voltage Rating:DC 50V.
Current Rating: 0.5 AMP.
Dielectric Withstanding Voltage: AC 250V.
Insulation Resistance: 50MΩ min.
Contact Resistance: 40mΩ max.
Operating Temperature: -55°C~+85°C.
***RoHS Compliant**

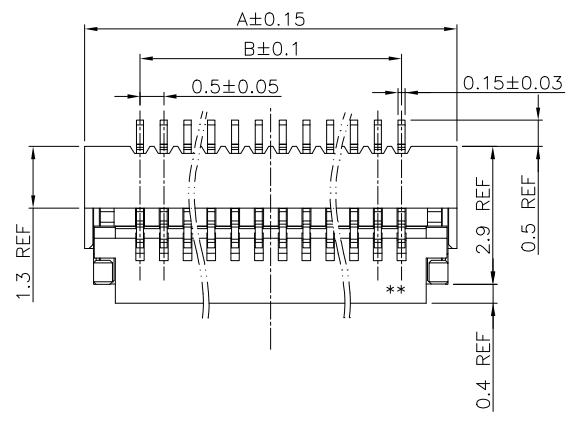
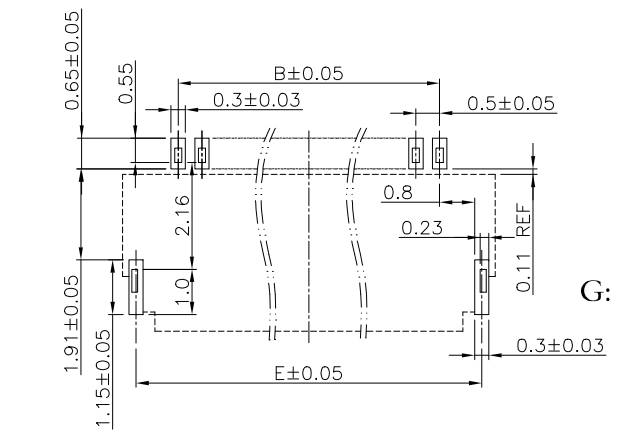
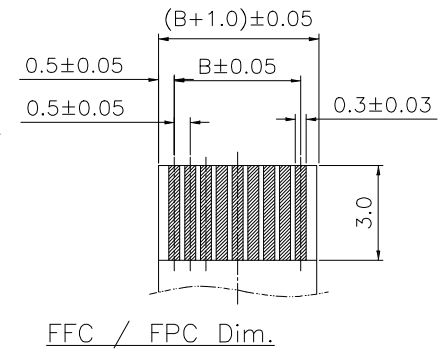
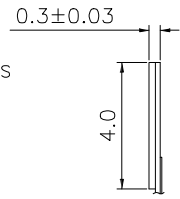
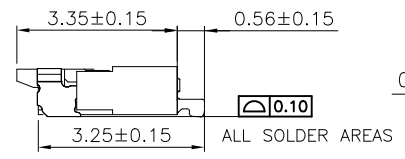
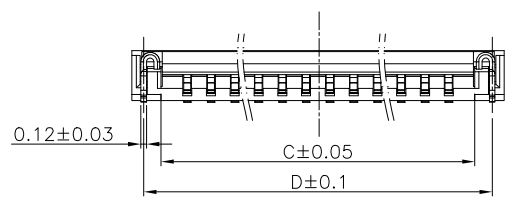

P.C.Board Layout

2531-D xx G 00 D B T
Series ———
Positions ———
G: Gold Plated ———
00:Gold Flash ———
D:SMD Type ———
T:Tape&Reel Package ———
B:0.3mm Thickness FFC/FPC ———

Positions	A	B	C	D	E
04	3.83	1.50	2.60	3.33	3.27
05	4.33	2.00	3.10	3.83	3.77
06	4.83	2.50	3.60	4.33	4.27
07	5.33	3.00	4.10	4.83	4.77
08	5.83	3.50	4.60	5.33	5.27
09	6.33	4.00	5.10	5.83	5.77
10	6.83	4.50	5.60	6.33	6.27
11	7.33	5.00	6.10	6.83	6.77
12	7.83	5.50	6.60	7.33	7.27
13	8.33	6.00	7.10	7.83	7.77
14	8.83	6.50	7.60	8.33	8.27
15	9.33	7.00	8.10	8.83	8.77
16	9.83	7.50	8.60	9.33	9.27
17	10.33	8.00	9.10	9.83	9.77
18	10.83	8.50	9.60	10.33	10.27
19	11.33	9.00	10.10	10.83	10.77
20	11.83	9.50	10.60	11.33	11.27
21	12.33	10.00	11.10	11.83	11.77
22	12.83	10.50	11.60	12.33	12.27
23	13.33	11.00	12.10	12.83	12.77
24	13.83	11.50	12.60	13.33	13.27
25	14.33	12.00	13.10	13.83	13.77
26	14.83	12.50	13.60	14.33	14.27
27	15.33	13.00	14.10	14.83	14.77
28	15.83	13.50	14.60	15.33	15.27
29	16.33	14.00	15.10	15.83	15.77
30	16.83	14.50	15.60	16.33	16.27
31	17.33	15.00	16.10	16.83	16.77
32	17.83	15.50	16.60	17.33	17.27
33	18.33	16.00	17.10	17.83	17.77
34	18.83	16.50	17.60	18.33	18.27
35	19.33	17.00	18.10	18.83	18.77
36	19.83	17.50	18.60	19.33	19.27
37	20.33	18.00	19.10	19.83	19.77
38	20.83	18.50	19.60	20.33	20.27
39	21.33	19.00	20.10	20.83	20.77
40	21.83	19.50	20.60	21.33	21.27
41	22.33	20.00	21.10	21.83	21.77
42	22.83	20.50	21.60	22.33	22.27
43	23.33	21.00	22.10	22.83	22.77
44	23.83	21.50	22.60	23.33	23.27
45	24.33	22.00	23.10	23.83	23.77
46	24.83	22.50	23.60	24.33	24.27
47	25.33	23.00	24.10	24.83	24.77
48	25.83	23.50	24.60	25.33	25.27
49	26.33	24.00	25.10	25.83	25.77
50	26.83	24.50	25.60	26.33	26.27

Tolerances	Dwg No.	2531D02004	
.x = ±0.30	Projection		
.xx = ±0.20	Unit	mm	Scale 1:N
.xxx = ±0.10	Drawn By	Martin 06/17'21	

Title: 2531-D Series
FFC/FPC Connector
Pitch 0.5mm Flip Lock Type
① 676

DUPIIN ELECTRONIC(KUNSHAN) CO., LTD.			
P/N: 2531-DxxG00DBT			
SHEET	1/1	Ver.No.	A1