

REV.	SPECIFICATION	ECN NO.	APPD.

**Material:**

Housing: PA66,UL94V-0.

Contact Pin: Brass, Tin Plated.

**Electrical Characteristics:**

Voltage Rating: 300V.

Current Rating: 10A.

Withstanding Voltage: 1.6KV.

Operating Temperature: -30°C~+105°C.

**\*RoHS Compliant**

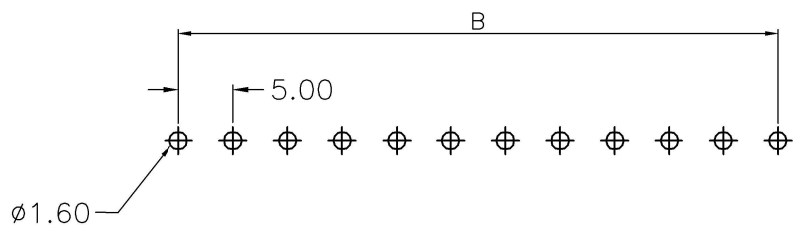
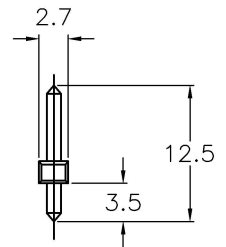
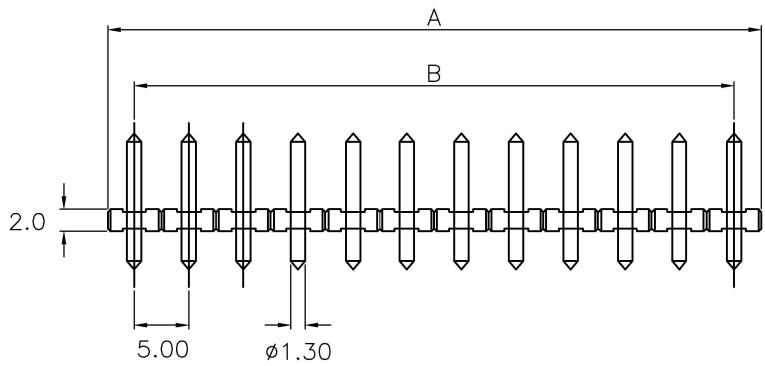
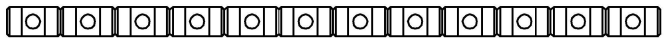

P.C.Board Layout

**8930-** Series    **F** F:Pitch 5.0mm    **035070** Manufacturing Code    **B** B:Black U: Blue    **xx** No. of Positions    **S** S:Straight    **B** B: Bulk Package

Positions	02 Thru 24
A	No. of Positions X5.0
B	(No. of Positions - 1) X5.0

Tolerances	Dwg. No.	8930D01012	
x = ±0.5	Projection	⊕ ↯	
.x = ±0.30	Unit	mm	Scale 1:1
.xx = ±0.15	Drawn By	Sherry 4/11'19	

Title: 8930 Series  
 5.0mm Terminal Block  
 (8500-xxMTS2-02)

<b>OUPIN</b>			
OUPIN ELECTRONIC(KUNSHAN) CO., LTD.			
P/N: 8930-F035070BxxSB			
SHEET	1/1	Ver.No.	A4

① 780